

**SAMSUNG**

# Samsung Air Conditioning





# Air Conditioning Solutions from a Trusted Brand

At the heart of family living is the home, a place full of special moments and wonderful memories where families live and grow in their own unique way.

At Samsung, we imagine all sorts of innovative ways to improve how your home functions and help it run smoothly – so you have more quality time for the joys of raising your family and looking after their well-being.

We're proud to say our Samsung brand is recognised as one of the world's leading intuitive and humanistic product design companies, and one of the world's top electronics producers.

Samsung air conditioners have been designed with the same passion for innovation and quality that has helped make Samsung one of the 2011 Best Global Brands\*.

Samsung air conditioning systems are held in high esteem around the world and have been selected for a multitude of developments including shopping centres, airports, stadiums and hotels.

Samsung continues to invest heavily in R&D, performance testing and quality control to deliver quality air conditioning systems to market.

## 2011 Best Global Brand

1. Coca Cola
2. IBM
3. Microsoft
- \*

17. SAMSUNG Electronics 

18. Louis Vuitton
- \*
20. Oracle
- \*
33. Canon
- \*
35. Sony

\*Source: Best Global Brand 2011. Interbrand.

# Samsung Ducted Air Conditioning System

Working to keep you and your family comfortable all year round

A Samsung inverter reverse cycle ducted air conditioner enables each room in your home to be cooled or heated by one system. Ducted systems are also relatively unobtrusive as the conditioned air is distributed through ducts hidden in your roof space to outlets in the ceiling of each room.

The primary components of your Samsung ducted system consist of the indoor unit, outdoor unit and controller.

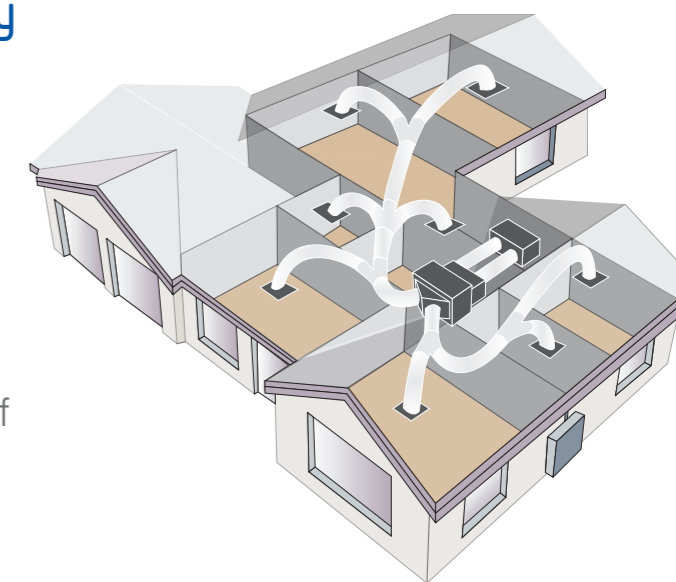

## Controller

A stylish and intuitive controller makes it easy to select desired temperature and fan speeds. Premium controller models also include a number of advanced features such as LCD backlighting and time scheduling.



## Outdoor Unit

The outdoor unit contains the Samsung Smart Inverter compressor which circulates refrigerant to the indoor unit and back again. The unit also contains a heat exchanging coil and a fan which blows air across the coil.



## Indoor Unit

The indoor unit, hidden from view, also contains a heat exchanging coil that cools the air in your house in cooling mode and warms it in heating mode. A fan then blows the conditioned air through the ducts installed in your roof space to the outlets in the ceiling of each room.



# Samsung Smart Inverter

## Intelligent and Effective Air

Samsung's Smart Inverter technology maintains the ideal temperature without constantly shutting off and switching on the compressor. It automatically adjusts the capacity of the system to cope with any temperature variances, helping to ensure that you experience minimal temperature fluctuation for optimal comfort.

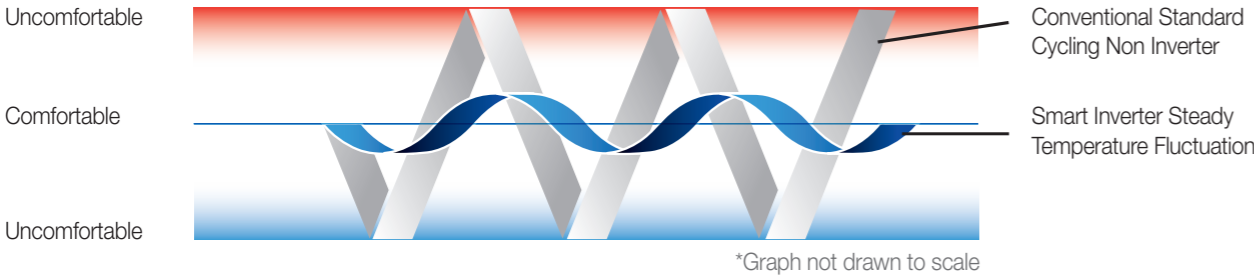

## Comfortable, Reliable Air

Samsung ducted air conditioners are designed to keep on working, even on those extremely hot or cold days. With an operating range of -15°C to 50°C outside air temperature for cooling, and -20°C to 24°C for heating, you can rest assured that your unit will work when you need it the most.



# Intuitive Control

## Easy to Use and Stylish in Design

To accompany the ducted air conditioning system is a choice of controller. The Standard and Premium controllers are designed to match and enhance the look of your home.

### Standard Controller Features

- **Quick-access on/off and temperature selection buttons**
- **On/off timer** allows the system to be started or stopped after a set time has passed
- **Built-in room temperature sensor**
- **Upper/Lower temperature limit setting** prevents temperature changes outside a set range
- **Automatic stop function** can set the unit to stop running after a set time has passed  
This can help prevent the system being left on accidentally
- **Child lock**
- **Button permission levels**
- **Filter replacement alert**



Optional Premium Controller MWR-WE10 featured

### Premium Controller Features

Includes all Standard Controller Features plus:

- **Clear and bright LCD Backlit Screen**
- **Real-time clock function**
- **Weekly operation scheduler** enables you to set your system to run automatically at certain times each day of the week



# Samsung Ducted System Models and Specifications

Model Name		Indoor Unit		NS071SDXEA/XSA	NS100HHXEH/XSA	NS125HHXEH/XSA	NS140HHXEH/XSA	NS155HHXEH/XSA	NS180HHXEH/XSA
		Outdoor Unit		RC071DHXEA/XSA	RC100DHXEH/XSA	RC125DHXEH/XSA	RC140DHXEH/XSA	RC155DHXEH/XSA	RC180DHXGH/XSA
System									
Mode				Reverse Cycle	Reverse Cycle	Reverse Cycle	Reverse Cycle	Reverse Cycle	Reverse Cycle
<b>Capacity</b>	Capacity (Nominal)	Cooling (Min / Std / Max)	kW	2.2 / 7.1 / 8.0	3.5 / 10.0 / 13.3	3.5 / 12.5 / 14.0	3.5 / 14.0 / 16.0	3.5 / 15.5 / 17.0	3.8 / 17.5 / 20.0
		Heating (Min / Std / Max)	kW	1.9 / 8.0 / 9.0	3.8 / 11.2 / 15.0	3.8 / 14.0 / 17.0	3.8 / 16.0 / 19.0	3.8 / 17.0 / 20.0	4.4 / 21.0 / 24.0
<b>Power</b>	Power Input (Nominal)	Cooling (Min / Std / Max)	kW	0.35 / 2.21 / 4.0	1.3 / 2.7 / 4.8	1.3 / 3.85 / 5.1	1.5 / 4.31 / 6.2	1.5 / 4.77 / 7.4	1.2 / 5.47 / 7.2
		Heating (Min / Std / Max)	kW	0.35 / 2.22 / 4.0	1.1 / 2.87 / 4.9	1.0 / 3.78 / 6.2	1.2 / 4.32 / 7.4	1.2 / 4.72 / 8.0	1.2 / 6.0 / 8.0
	Current Input (Nominal)	Cooling (Min / Std / Max)	A	2.0 / 10.5 / 21.0	6.5 / 12.2 / 20.7	6.5 / 17.0 / 22.5	7.0 / 19.0 / 28.0	7.0 / 21.5 / 32.0	2.6 / 9.1 / 11.3
		Heating (Min / Std / Max)	A	2.0 / 10.5 / 21.0	6.0 / 12.9 / 21.2	6.0 / 16.5 / 26.0	6.5 / 19.0 / 32.0	6.5 / 21.0 / 34.0	2.3 / 9.9 / 12.0
Circuit Breaker (MCCB+ELB / ELCB)		A		25	30	30	40	40	20
<b>Energy Efficiency</b>		AEER (Annual Energy Efficiency Ratio)		-	3.15	3.65	3.21	3.22	3.18
		ACOP (Annual Coefficient of Performance)		-	3.54	3.85	3.66	3.67	3.48
<b>Piping Connections</b>	Liquid Pipe		Φ, mm(inch)	6.35 (1/4)	9.52 (3/8)	9.52 (3/8)	9.52 (3/8)	9.52 (3/8)	9.52 (3/8)
	Gas Pipe		Φ, mm(inch)	15.88 (5/8)	19.05 (3/4)	19.05 (3/4)	19.05 (3/4)	19.05 (3/4)	19.05 (3/4)
	Installation Limitation	Max. Length (Outdoor to indoor)		m	50.0	75.0	75.0	75.0	75.0
		Max. Height (Between ID/OD)		m	30.0	30.0	30.0	30.0	30.0
<b>Refrigerant</b>		Type		-	R410A	R410A	R410A	R410A	R410A
		Factory Charging		kg	1.8 (Charged for 5m)	3.4 (Charged for 30m)	3.4 (Charged for 30m)	4.4 (Charged for 30m)	4.8 (Charged for 30m)
<b>Indoor unit</b>									
<b>Power Supply</b>		Φ, #, V, Hz		1, 2, 220~240, 50	1, 2, 220~240, 50	1, 2, 220~240, 50	1, 2, 220~240, 50	1, 2, 220~240, 50	1, 2, 220~240, 50
<b>Fan</b>		Type		-	Sirocco Fan	Sirocco Fan	Sirocco Fan	Sirocco Fan	Sirocco Fan
		Air Flow Rate	High / Mid / Low	ℓ/s	317 / 283 / 250	600 / 550 / 500	750 / 633 / 517	833 / 733 / 633	1,067 / 933 / 833
		External Static Pressure	Max / Std / Min	Pa	98.1 / 39.2 / 0	196 / 60 / 19	196 / 60 / 19	196 / 60 / 19	245 / 60 / 19
<b>Sound</b>		Sound Pressure		High / Mid / Low	dB(A)	39 / 35	46 / 40.5 / 35	48 / 42.5 / 37	50 / 44.5 / 39
		Supply Air Spigot (WxH)		mm	904 x 185	1000 x 253	1000 x 253	1000 x 253	1188 x 385
		Return Air Spigot (WxH)		mm	985 x 178*	1160 x 276	1160 x 276	1160 x 276	1188 x 385
<b>External Dimension</b>		Net Weight		kg	33	58.0	60.0	60.0	95.0
		Shipping Weight		kg	40	67.5	69.5	69.5	105.0
		Net Dimensions (WxHxD)		mm	1,150 x 260 x 480	1,200 x 360 x 650	1,200 x 360 x 650	1,200 x 360 x 650	1,240 x 470 x 1,040
		Shipping Dimensions (WxHxD)		mm	1,405 x 354 x 593	1,447 x 425 x 769	1,447 x 425 x 769	1,447 x 425 x 769	1,507 x 558 x 1,155
<b>Outdoor unit</b>									
<b>Power Supply</b>		Φ, #, V, Hz		1, 2, 220~240, 50	1, 2, 220~240, 50	1, 2, 220~240, 50	1, 2, 220~240, 50	1, 2, 220~240, 50	3, 4, 380~415, 50
<b>Compressor</b>		Type		-	Twin BLDC Rotary	Twin BLDC Rotary	Twin BLDC Rotary	Twin BLDC Rotary	Twin BLDC Rotary
<b>Fan</b>		Air Flow Rate		Cooling / Heating	ℓ/s	833 / 800	1,508 / 1,508	1,508 / 1,508	1,683 / 1,683
<b>Sound</b>		Sound Pressure		Cooling / Heating	dB(A)	49 / 51	50 / 52	51 / 53	52 / 54
		Net Weight		kg	55	88.0	88.0	99.0	102.0
		Shipping Weight		kg	59	98.0	98.0	109.0	111.0
<b>Dimension</b>		Net Dimensions (WxHxD)		mm	880 x 798 x 310	940 x 1,210 x 330	940 x 1,210 x 330	940 x 1,420 x 330	940 x 1,420 x 330
		Shipping Dimensions (WxHxD)		mm	1,023 x 889 x 416	995 x 1,338 x 426	995 x 1,338 x 426	995 x 1,548 x 426	995 x 1,548 x 426
<b>Operating Temp. Range</b>		Cooling		°C	-15 ~ 50	-15 ~ 50	-15 ~ 50	-15 ~ 50	-15 ~ 50
		Heating		°C	-20 ~ 24	-20 ~ 24	-20 ~ 24	-20 ~ 24	-20 ~ 24

\* Specifications may be subject to change without prior notice for product improvement.

\*1) Nominal cooling capacities are based on;

- Indoor temperature: 27°C DB, 19°C WB / Outdoor temperature: 35°C DB, 24°C WB
- Equivalent refrigerant piping: 7.5m, Level differences: 0m

\*2) Nominal heating capacities are based on;

- Indoor temperature: 20°C DB, 15°C WB / Outdoor temperature: 7°C DB, 6°C WB
- Equivalent refrigerant piping: 7.5m, Level differences: 0m

\*3) Sound pressure was acquired in a dead room. Thus actual noise level may be different depending on the installation conditions.

\*4) NS071SDXEA/XSA return air flange not supplied. Dimension shown in above table is the opening size.

# Samsung Air Conditioning Committed to After Sales and Warranty Support

## Peace Of Mind

Rest assured that you are buying a quality air conditioner with Samsung's 5 year parts and labour warranty on products featured in this brochure. Refer to the warranty card included with your product for full details.



## Product Support Line

If you have any concerns about your product simply call 1300 362 603 and our friendly staff will assist with your enquiry and book a service call if required.



## National Samsung Service Network

Our national network of Authorised Service Centres and Customer Service Plazas are on hand to support your product. Our specialist technicians will provide a fast and effective response.

## MEPS Compliant

Air conditioners sold in Australia are required to meet Minimum Energy Performance Standards (MEPS) set by the Government.

These standards are based on the ratio of a system's energy input versus its capacity.

On the 1st of October 2011 the latest minimum efficiency levels came into effect. Samsung is proud to state that our latest inverter ducted, 4 way cassette and wall hung split systems are fully compliant with these MEPS levels.



Learn more about  
Samsung Air Conditioning at  
[www.samsung.com.au](http://www.samsung.com.au)

Samsung Electronics Australia  
Quad Samsung, 8 Parkview Drive  
Homebush Bay NSW 2127 Australia

